

MODEL :

S6C

(See Instructions 1002-C00 for Installation, Operation and Maintenance)

Section	1002
Effective	July 2008
Replaces	August 2005

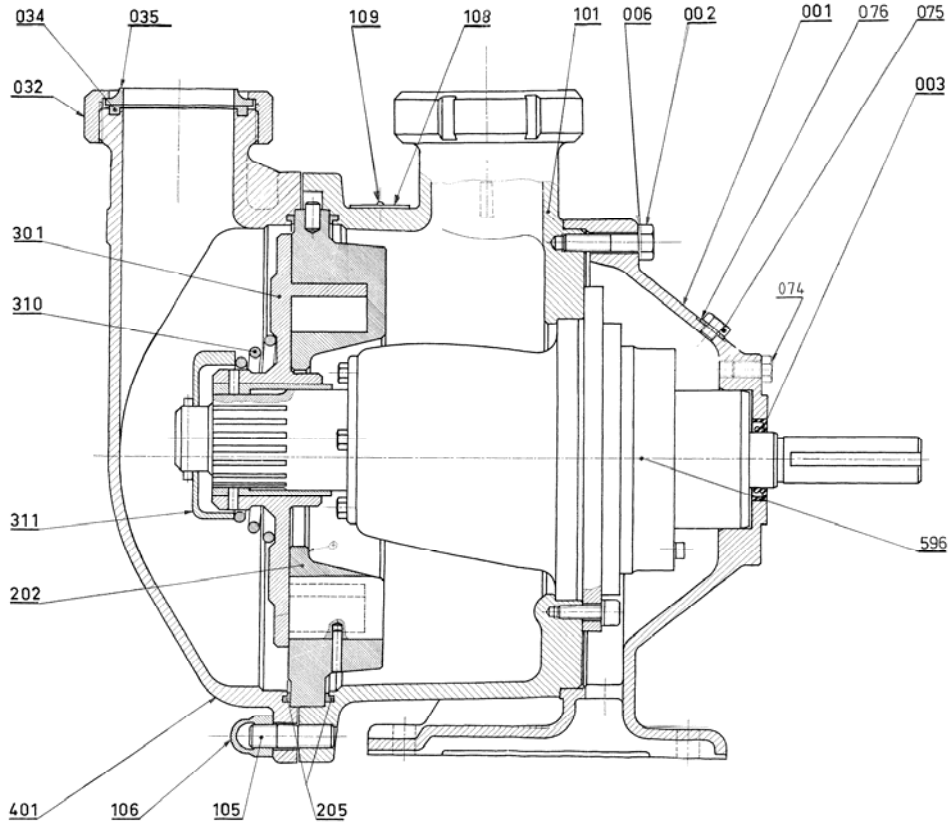

Reference			Description	Quantity		ARTICLE CODE		Wear parts
Ass.	Part	Available		Order	In Pump	S6C AL	S6C CH	
5		◆	<b>Support foot pump complete</b>	1		301568.00		
	001		Support foot		(1)			
	002		Foot screw		(4)			
	003		Leap seal		(1)			
	006		Washer		(4)			
	074		Plug		(4)			
	075		Plug		(1)			
	076		Gasket		(1)			
30		◆	<b>Set FKM SMS 63 connections</b>	1		311576.00		
30		◆	<b>Set FKM DIN 65 connections</b>	1		311666.00		
30		◆	<b>Set EPDM SMS 63 connections</b>	1		301583.00		
30		◆	<b>Set EPDM DIN 65 connections</b>	1		304516.00		
	1012		Gasket		(2)			
	1017		Locked nut		(2)			
	1019		Smooth pipe		(2)			
45		◆	<b>Set smooth pipe FKM 63</b>	1		312697.01		
45		◆	<b>Set smooth pipe EPDM 63</b>	1		301605.00		
	1012		Gasket		(2)			
	1017		Locked nut		(2)			
	1019		Smooth pipe		(2)			

(◆) Sets of parts or (▲) parts available to order

Keep this parts lists with Installation, Operation and Maintenance Instructions

Reference			Description	Quantity		ARTICLE CODE		Wear parts
Ass.	Part	Available		Order	In Pump	S6C AL	S6C CH	
100		◆	Polish Connection pipe SMS 63	1		309104.00		
100		◆	Polish Connection pipe DIN 65	1		304514.00		
100		◆	Connection pipe SMS 63	1			309184.00	
100		◆	Connection pipe DIN 65	1			312580.00	
	101		Inlet tube		(1)			
	105		Stud		(8)			
	106		Blind nut		(8)			
	108		Name plate		(1)			
	109		Rivet		(2)			
110		◆	Set screws	1		304867.00		
	106		Blind nut		(8)			
120		◆	Set gaskets connection FKM SMS 63	1		311583.00		
120		◆	Set gaskets connection FKM DIN 65	1		311654.00		
120		◆	Set gaskets connection EPDM SMS 63	1		304869.00		
120		◆	Set gaskets connection EPDM DIN 65	1		304872.00		
	034		Gasket		(6)			
200		◆	Set Cylinder/Piston	1		313415.00		•
	201		Cylinder		(1)			
	301		Piston		(1)			
310		▲	Spring back piston	1		201227		
310		▲	Strong spring back piston	1		216494		
311		▲	Back piston support	1		206079		
206		◆	FKM Oring	1		304864.00		
206		◆	EPDM Oring	1		304865.00		
	205		O-ring		(2)			
401		▲	Polish bottom SMS 63	1		211775		
401		▲	Polish bottom DIN 65	1		211777		
401		▲	Bottom SMS 63	1			211774	
401		▲	Bottom DIN 65	1			211776	
596		◆	Complete Transmission block FKM	1		502038.01		•
596		◆	Complete transmission block FKM with detection	1		513910.01		•
596		◆	Complete Transmission block EPDM	1		503817.01		•
596		◆	Complete Transmission block EPDM with detection	1		513911.01		•

(◆) Sets of parts or (▲) parts available to order

Keep this parts lists with Installation, Operation and Maintenance Instructions



Z.I. la Plaine des Isles - 2 rue des Caillottes F-89000 AUXERRE - FRANCE

Tel : +33 (0)3 86 49 86 30 • Fax : +33 (0)3 86 49 87 17

contact@mouvex.com - www.mouvex.com