

# **C4 A - C4 A HT**

# **C8 A - C8 A HT**

# **PUMPS**



**INSTALLATION**

**OPERATION**

**MAINTENANCE**

# ECCENTRIC PISTON PUMP MOUVEX PRINCIPLE

## SAFETY INSTRUCTIONS, STORAGE, INSTALLATION AND MAINTENANCE MODELS : C4 A - C4 A HT - C8 A - C8 A HT



### TECHNICAL CHARACTERISTICS

- Maximum pump speed : **750 rpm**
- Maximum running temperature :
  - C4 A - C8 A..... 100°C
  - C4 A HT - C8 A HT ..... 150°C
- Maximum suction pressure :
  - In normal use, the suction pressure must be higher than the required NPSH and **less than 1 bar** (14,50 psi).
  - Pump **stopped**, the pressure must not exceed **6 bar** (87 psi).
- Maximum discharge pressure :
  - C4 A C4 A HT .....9 bar (130,50 psi)\*
  - C8 A C8 A HT .....5 bar (72,50 psi)\*
- Maximum pressure jacket : **8 bar** (116 psi)
- Cylinder capacity :
  - C4 A C4 A HT .....0,108 litre
  - C8 A C8 A HT .....0,178 litre

\* When the pump works with an inlet pressure less than zero, the maximum outlet pressure will be calculated as if the inlet pressure is equal to zero.

Pump N° :

Commissioning date :

### SAFETY INFORMATIONS



#### This is a SAFETY ALERT SYMBOL

When you see this symbol on the product, or in the manual, look for one of the following signal words and be alert to the potential for personal injury, death or major property damage.



Warns of hazards that **WILL** cause serious personal injury, death or major property damage



Warns of hazards that **CAN** cause serious personal injury, death or major property damage.



Warns of hazards that **CAN** cause personal injury or property damage.

#### NOTICE

Indicates special instructions which are very important and must be followed.

### SUMMARY

*Page*

<b>1. OVERALL DIMENSIONS</b> .....	<b>3</b>
<b>2. INSTALLATION</b> .....	<b>5</b>
2.1 Orientation of the pump ports .....	5
2.2 Direction of rotation .....	5
2.3 Protection of the pump installation .....	5
2.4 Hoisting devices .....	6
2.5 Unit Assembly .....	6
<b>3. UTILISATION</b> .....	<b>8</b>
3.1 Noise level .....	8
3.2 Commissioning .....	8
3.3 Dry running .....	8
3.4 Pump stop .....	8
<b>4. MAINTENANCE</b> .....	<b>9</b>
4.1 Necessary tools .....	9
<b>5. OPENING OF THE PUMP</b> .....	<b>9</b>
5.1 Assembly / Dismantling .....	10
5.2 Checking of parts .....	11
<b>6. REASSEMBLY OF CYLINDER/PISTON</b> .....	<b>12</b>
<b>7. PROTECTION OF THE BELLOWS</b> .....	<b>13</b>
<b>8. CHANGING THE LIP SEALS</b> .....	<b>14</b>
<b>9. CHANGING THE ORIENTATION OF THE DISCHARGE PORT</b> .....	<b>15</b>
<b>10. BYPASS</b> .....	<b>16</b>
10.1 Bypass adjustment .....	16
10.2 Changing the spring .....	16
10.3 Replacement of the seals .....	16
<b>11. HEATING JACKET (OPTION)</b> .....	<b>17</b>
11.1 Replacement of the jacket seal .....	17
11.2 Bleed (included with jacket option) .....	17
<b>12. DRAINING OF BEARING</b> .....	<b>18</b>



# 1. OVERALL DIMENSIONS (continued)

## C4 A HT - C8 A HT

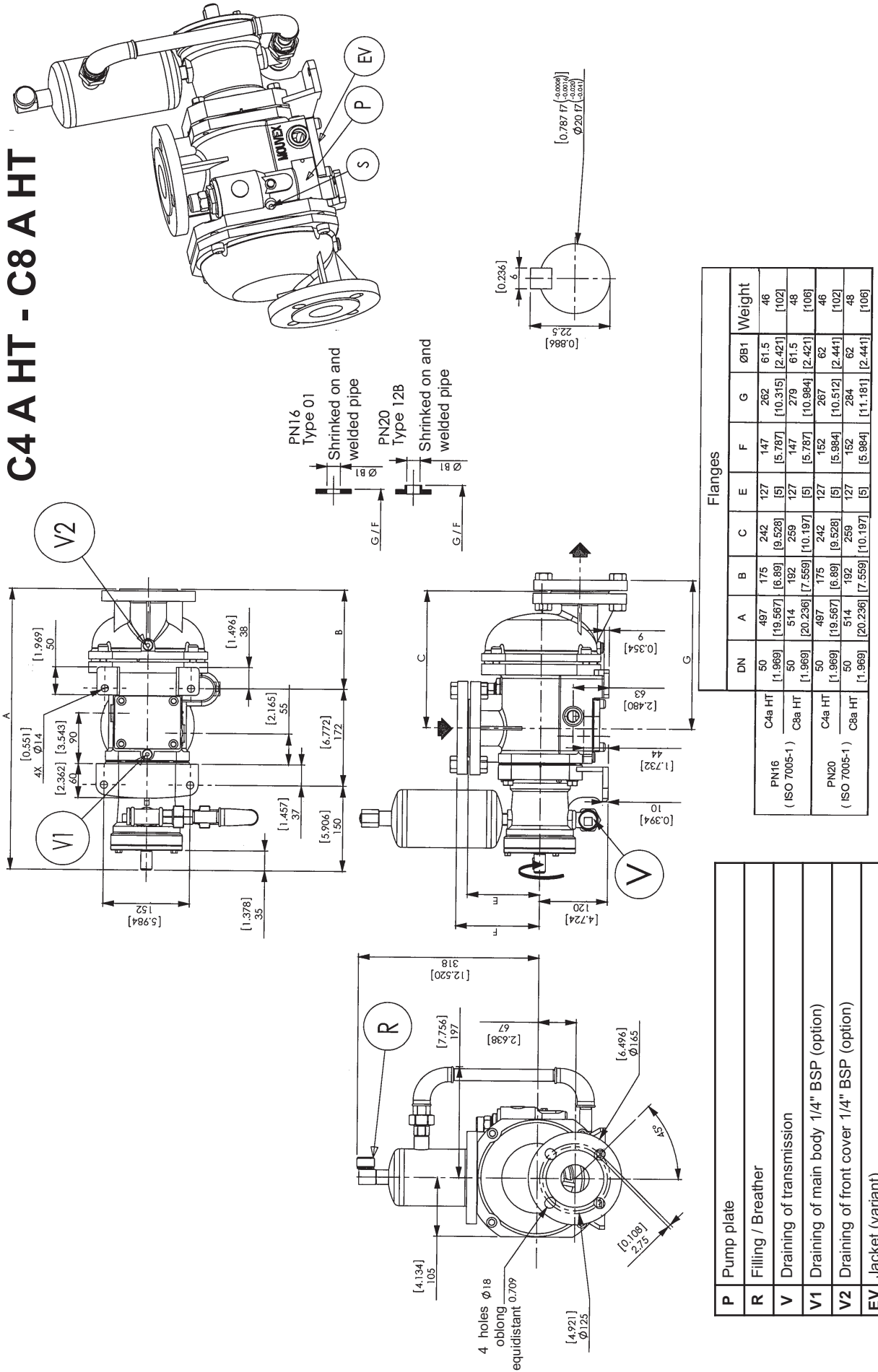

## 2. INSTALLATION

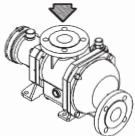
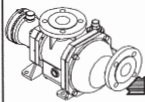
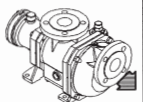
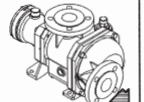
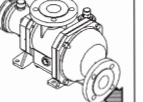
POSITIONS POSSIBLES				
SUCTION				
DISCHARGE	1 	2 	3 	4 STANDARD 

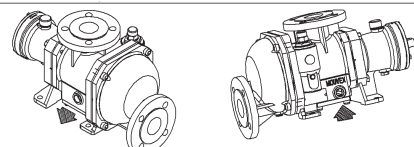
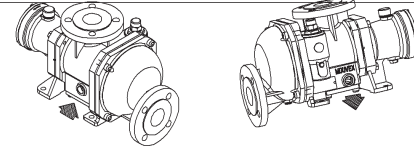
JACKET CONNECTION (variant) 1/2" CYLINDER GAS	
LIQUID	
STEAM	

The C Series pump is a selfpriming volumetric PD pump.

Therefore, the pump must not run on a circuit with a closed valve. This is valid both for the suction circuit and for the discharge circuit.

### 2.1 ORIENTATION OF THE PUMP PORTS

The suction part axis is placed on the top.

The discharge port may be oriented in various positions.

If the port positions needs to be changed at any time, see the corresponding paragraph.

#### NOTICE

**C-Series pumps remains drainable whatever position is chosen for the inlet port, but the outlet port must be at the bottom (position 4) to keep the self-draining capability.**

### 2.2 DIRECTION OF ROTATION

When looking at the shaft, the rotation will be clockwise. When looking at the front cover, the direction of rotation will be anti-clockwise. An arrow situated on the bearing housing indicates the correct direction of rotation.



Verification of the correct rotation direction :

Turn the pump the wrong way is not dangerous for the pump.

### 2.3 PROTECTION OF THE PUMP INSTALLATION

- For ease of maintenance, it is a good idea to place isolation valves before and after the pump. The sizing of these valves must correspond to the diameter of the pipes.
- Before any start-up, during operation or complete stopping of the pump, make sure the valves are open.
- During stop periods, with the pump full of product, either the suction or discharge circuit must be left open to enable expansion or contraction of the pumped product through reheating or cooling. If this instruction is not complied with, The bellows may be damaged and lead to premate failure.
- In case of floded suction, it is possible to install a liquid detector in the place of the transmission breather.

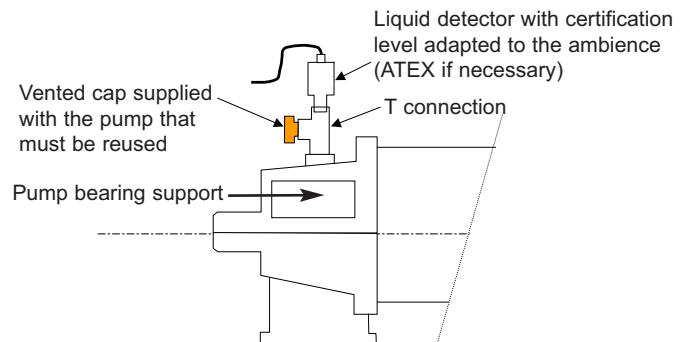

- The bearing must be ventilate at all times, therefore the breather mounted on the bearing must be re-used. Never put the bung on.
- This detector will enable the user to be informed in the case of failure of the bellows. In the case of detection, the installer must make sure the pump is stopped and the isolating valves are closed. Non compliance with this instruction can lead to the pumped product being spilt outside the pump.
- The stop time may lead to cooling of the product in the pump and therefore to an increase in viscosity. If this is the case, we recommend re-starting the pump at a speed adapted to this new viscosity (starting pump). Once the product arrives in the pump at the installation definition temperature, the pump may run at the speed specified for this application.

## 2. INSTALLATION (continued)

- Protection against excess pressure :

The pump must be protected against excess pressure. It can be delivered with a pressure switch to carry out this function.

If protection is provided by a control valve, check that the system does not generate excess pressure at the bellows (particularly if there are water hammers). Operating in this way would damage the bellows and shorten their lifetime.

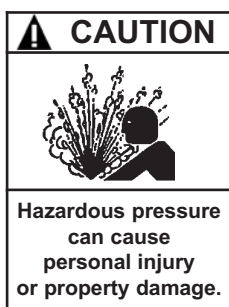

INCORRECT SETTINGS OF THE PRESSURE RELIEF VALVE CAN CAUSE PUMP COMPONENT FAILURE, PERSONAL INJURY, AND PROPERTY DAMAGE.



FAILURE TO INSTALL ADEQUATELY SIZED PRESSURE RELIEF VALVE(S) CAN CAUSE PROPERTY DAMAGE, PERSONAL INJURY OR DEATH.

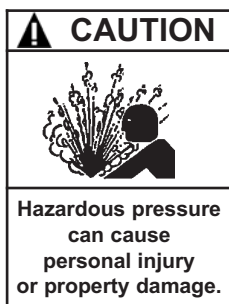

PUMPS OPERATING AGAINST A CLOSED VALVE CAN CAUSE SYSTEM FAILURE, PERSONAL INJURY AND PROPERTY DAMAGE.

- Protection against foreign bodies :

The pump and the installation must also be protected against any risk of damage through the passage of foreign bodies by mounting a pre-filter at the pump suction.

In the case of foreseeable clogging of the pre-filter, we recommend using a vacuum switch to inform the user of pre-filter clogging. Prolonged running under cavitation may damage the pump.

### 2.4 HOISTING DEVICES

Hoisting point :



### 2.5 UNIT ASSEMBLY

The following instructions apply to pumps delivered with a bare shaft or for MOUVEX motor-driven pump units (if the latter have no specific instruction notice).

#### 2.5.1 INSTALLATION OF UNITS



BE CAREFUL WITH THE WEIGHT OF THE PARTS WHEN THEY ARE BEING REMOVED.

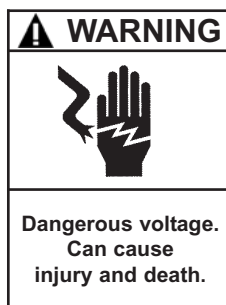

DISCONNECT THE ELECTRICITY SUPPLY BEFORE ANY MAINTENANCE OPERATION.

The base below the unit is fundamental to ensuring correct operation and long service life.

The unit's base must be flat, level and sufficiently resistant to absorb the stresses caused by the motor-driven pump unit without deformation (if it is made of concrete, it must comply with the BAEL 91 standard).

If the unit is fastened using securing lugs or bolts, it must be carefully wedged to avoid deforming the frame while the bolts are tightened. A deformed frame would apply damaging stresses on the pump and the drive mechanism and misalign the coupling, causing vibrations, noise and premature wear. Ensure that the frame is well above the floor, except from the support plates.

## 2. INSTALLATION (continued)

If the unit is to be used in a food environment, support plates that allow the unit to be lifted for easier cleaning are recommended.

Allow, if possible, a clear space of approximately 50 cm on each side of the motor-driven pump unit (overall dimensions) to facilitate cleaning and give access if necessary to the pump, reduction gear and motor fastening nuts. In all cases, the dimensions around the motor-driven pump unit must be designed to give the space required for dismantling the pump (if the need arises, use the values given on the overall dimension drawing).

For staff and equipment protection, the frame includes a ground connection point that should be used.

### 2.5.2 ALIGNMENT OF THE MOTOR/PUMP OR REDUCTION GEAR/PUMP SHAFTS

<b>⚠ WARNING</b>

<b>Do not operate without guard in place.</b>

IF OPERATED WITHOUT THE SHAFT GUARD, THERE IS CONSIDERABLE RISK OF SEVERE PERSONAL INJURY, SIGNIFICANT PROPERTY DAMAGE OR EVEN DEATH.

<b>⚠ WARNING</b>

<b>Dangerous voltage. Can cause injury and death.</b>

DISCONNECT THE ELECTRICITY SUPPLY BEFORE ANY MAINTENANCE OPERATION.

**NEVER START A UNIT IF THE COUPLING ALIGNMENT IS INCORRECT. THIS IS A CONDITION OF OUR GUARANTEE.**

#### REMINDER :

Coupling must never be used to compensate for a misalignment.

To control the alignment between the coupling and the shaft, use a straight-edge for concentricity and thickness gauges for angular misalignment (see instructions of the coupling for authorised values).

The 3 figures below show in detail the operation and the possible defects :

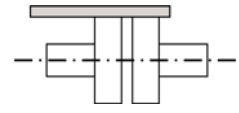
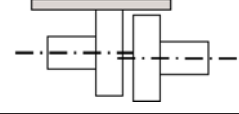
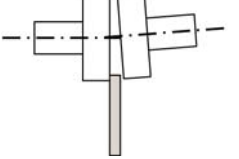
<b>Make this check for 4 points: up - down - left - right</b>	
	<b>Correct</b>
	<b>Out-of-parallelism</b>
	<b>Angular defect</b>

Controlling the alignment at each stage of the installation is important to be sure that none of these stages have generated stresses on the unit or the pump :

- after fastening on the foundations.
- after fastening the pipes.
- after the pump has been operated at the normal operating temperature.

Where the pumps are supplied assembled as a unit, the motor and pump shafts have been perfectly aligned in the factory before delivery, but they must be systematically controlled on acceptance at the site and realigned if necessary.

To do this, do not modify the wedging of the various parts, but check the flatness of the support surface and use the adjustable foot to clear the frame of stresses that could affect it.

### 2.5.3 ELECTIC MOTORS

<b>⚠ WARNING</b>

<b>Dangerous voltage. Can cause injury and death.</b>

DISCONNECT THE ELECTRICITY SUPPLY BEFORE ANY MAINTENANCE OPERATION.

Check the compatibility of the instructions on the motor with the supply voltage.

Follow the wiring diagram, use wiring that is appropriate for the power and be particularly careful about the contacts which must be well tightened.

The motors should be protected with circuit breakers and suitable fuses. Connect the regulatory electrical grounding.

## 2. INSTALLATION (continued)

### 2.5.4 THERMIC MOTORS



THE SURFACES CAN BE AT A TEMPERATURE LIABLE TO CAUSE INJURY OR SEVERE DAMAGE.

Do not forget that these motors are not reversible. It is absolutely necessary to carefully control the suction and discharge sides of the pump before connecting the group to the piping.

Using electric motors is very common now; however, we strongly advise careful reading of the accompanying instruction manual.

### 2.5.5 CONTROL OF THE SENSE OF ROTATION



TAKE ALL NECESSARY MEASURES TO RENDER ANY START-UP, EVEN ACCIDENTAL, OF THE PUMP DURING THE WORK IMPOSSIBLE.

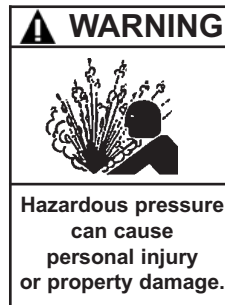

IT IS IMPERATIVE THAT THE HYDRAULIC PRESSURE IS RELEASED BEFORE EACH MAINTENANCE OPERATION TO AVOID PERSONAL INJURY OR MATERIAL DAMAGE

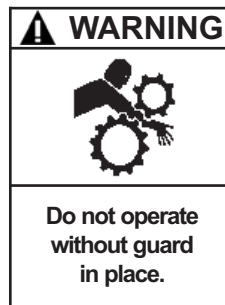

A DRIVE SHAFT GUARD BETWEEN THE PTO AND PUMP MUST BE PROVIDED TO PREVENT PERSONAL INJURY, PROPERTY DAMAGE, OR DEATH.

This control needs to be done with no liquid pumped through the pump, and both the suction and discharge circuits venting to avoid generating unexpected pressure (at the suction side, for example). This will ensure that the control will not damage either the pump or the installation.

Start the pump empty to check that the connections are good and that the direction of rotation corresponds to the suction and discharge direction on the installation. If it is necessary to reverse the direction of rotation, follow the instructions below :

Three-phase motor : switch any 2 current input wires.

Bi-phase motor : switch two same phase wires.

Single-phase motor : follow the instructions on the notice supplied with the motor.

## 3. UTILISATION

### 3.1 NOISE LEVEL

The sound level of a pump is greatly influenced by its conditions of use. Cavitation and pumping products with high gas contents generally increases the sound level.

Under the following pumping conditions :

- excluding cavitation
- discharge pressure :
  - C4 : . . . . . 9 bar (130,50 psi)
  - C8 : . . . . . 5 bar (72,50 psi)
- speed of rotation 750 rpm
- water product or equivalent

The sound level reached for the C4 / C8 pump in good conditions without the drive is less than 79 dB(A).

### 3.2 COMMISSIONING

Make sure that the circuit valves are open before starting the pump.

To avoid any risk of polluting the product to be pumped, rinse the whole installation before starting-up so as to eliminate any contaminants that may remain in the piping, tanks etc. at the time of installation.

### 3.3 DRY RUNNING

The C series pump is self priming and is capable of emptying the pipes. To do this, it can run dry for a maximum duration of 5 minutes.

### 3.4 PUMP STOP

So as not to damage the pump, make sure that the pump is completely stopped before closing the valves.

---

## 4. MAINTENANCE

### 4.1 NECESSARY TOOLS

- Hexagonal socket wrench no. 6-8-10
- Socket wrench 16
- 10-14-18-19-24-26-38 Open-end spanner
- Monkey spanner (opening 50 mm)
- Hub puller
- Mallet

Tightened torques :

- M10 : 30 Nm
- M12 : 50 Nm
- M18 : 120 Nm

---

## 5. OPENING OF THE PUMP

<b>WARNING</b>
Any unforeseen start-up can cause serious injuries or important material damages.

TAKE ALL NECESSARY MEASURES TO RENDER ANY START-UP, EVEN ACCIDENTAL, OF THE PUMP DURING THE WORK IMPOSSIBLE.

<b>WARNING</b>
Hazardous pressure can cause personal injury or property damage.

DISCONNECTING THE FLUID OR PRESSURE CONTAINMENT COMPONENTS DURING PUMP OPERATION CAN CAUSE SERIOUS PERSONAL INJURY, DEATH OR MAJOR PROPERTY DAMAGE.

<b>CAUTION</b>
Hazardous pressure can cause personal injury or property damage.

FAILURE TO RELIEVE SYSTEM PRESSURE PRIOR TO PERFORMING PUMP SERVICE OR MAINTENANCE CAN CAUSE PERSONAL INJURY OR PROPERTY DAMAGE.

<b>WARNING</b>
Hazardous or toxic fluids can cause serious injury.

IF PUMPING HAZARDOUS OR TOXIC FLUIDS, THE SYSTEM MUST BE FLUSHED PRIOR TO PERFORMING ANY SERVICE OPERATION.

<b>WARNING</b>
The weight of the parts can be dangerous and may provoke bodily injuries or material damages.

BE CAREFUL WITH THE WEIGHT OF THE PARTS WHEN THEY ARE BEING REMOVED.

<b>CAUTION</b>
Slippery lubricant. Spills should be cleaned up.

THE PUMP LUBRICANT IS VERY SLIPPERY AND MAY CAUSE SERIOUS INJURY. ANY SPILLS MUST BE CLEANED UP.

## 5. OPENING OF THE PUMP (continued)

### 5.1 ASSEMBLY / DISMANTLING

Before any dismantling, make sure that the pump has been drained and take the necessary measures to avoid starting-up. No start-up, even accidental, must be allowed.

- Hold the piston 301 with a monkey wrench (opening 50 mm) and unscrew the nut 304 and its seal 305.

It is important to keep a good grip on the piston, its rotation could lead to deterioration of the bellows.

- Disconnect the pump from the discharge pipe.
- Unscrew the 4 screws 106.
- Remove the front cover 401

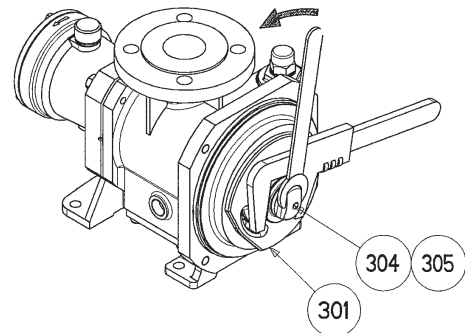
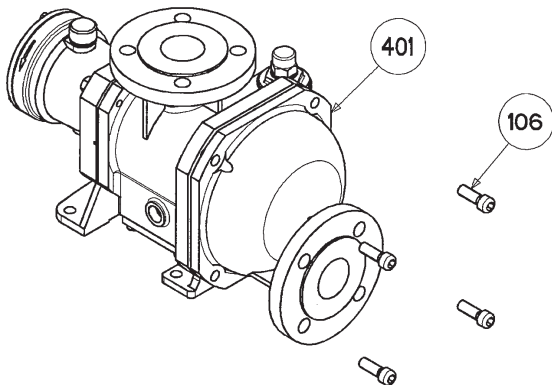

- With the help of a hub puller, extract the piston 301.

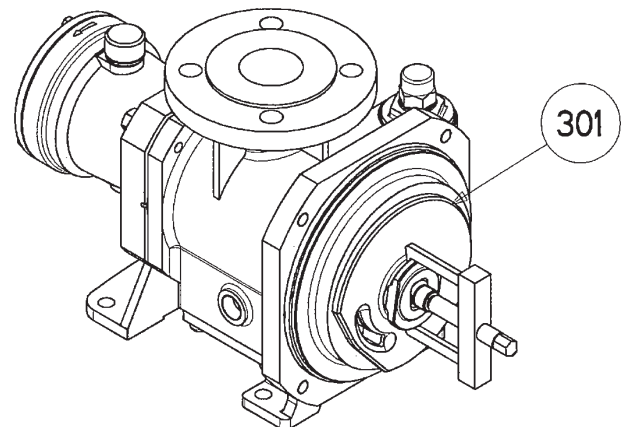

- Remove the front cover 401 with its seal 205.

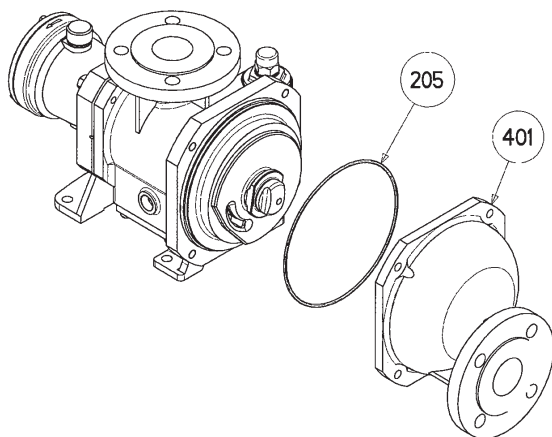

- Remove the cylinder 201 and the seals 113, 306 and 307.

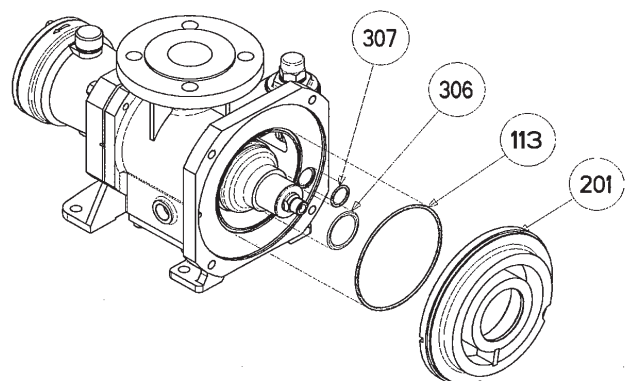

## 5. OPENING OF THE PUMP (continued)

### 5.2 CHECKING OF PARTS

The piston **301** and the cylinder **201** are active parts (wear parts) on which the pump's efficiency directly depends. It is therefore advisable to regularly check the pump's efficiency and replace the cylinder / piston if it decreases.

In addition, as using a cylinder / piston that is too worn may damage the pump's transmission system, it is advisable to replace the cylinder / piston if the maximum acceptable wear dimensions defined in the table below are reached.

MOUVEX offers its customers a "Standard Exchange" service, consisting of the repairing of worn parts, to allow parts to be reused without reducing the pump's efficiency.

In order to benefit from this service, the parts must be within the minimum wear dimensions for Standard Exchange defined in the table below.

As changes in the pump's efficiency depend on the conditions of use (pressure, rotation speed, liquid pumped, etc.), MOUVEX recommends that users define the monitoring ranges and the preventive maintenance schedule according to their own experience.

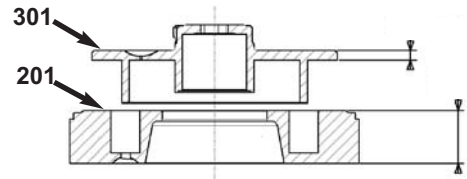

		Piston <b>301</b> mm (inch)	Cylinder <b>201</b> mm (inch)
C4 A C4 A HT	New dimension	7 (0,276)	32 (1,260)
	Minimum wear dimension acceptable	5 (0,197)	30 (1,181)
	Minimum wear dimension for exchange unit	6,5 (0,256)	31,5 (1,240)
C8 A C8 A HT	New dimension	7 (0,276)	49 (1,929)
	Minimum wear dimension acceptable	5 (0,197)	47 (1,850)
	Minimum wear dimension for exchange unit	6,5 (0,256)	48,5 (1,909)

## 6. REASSEMBLY OF CYLINDER/PISTON

- Check the state of the seals **306**, **307** and **113**, replace them if necessary.
- Position the seals **113** and **307** on the main body and the seal **306** on the hub.

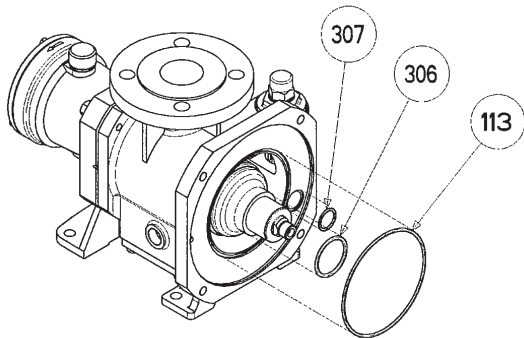

- Position the cylinder **201** such that the locating pin fits **101** into the notch of the back of the cylinder.

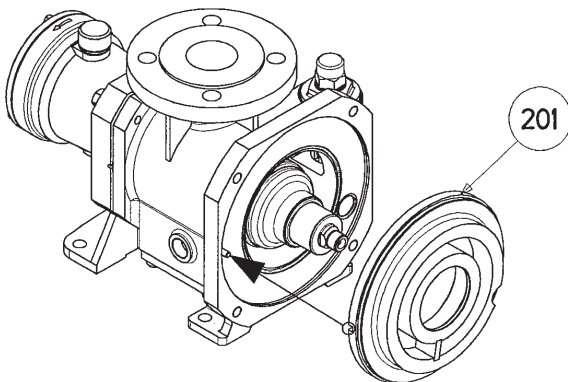

- Engage the piston **301** on the transmission hub **596**, the gap of the piston facing the cylinder partition **201**.

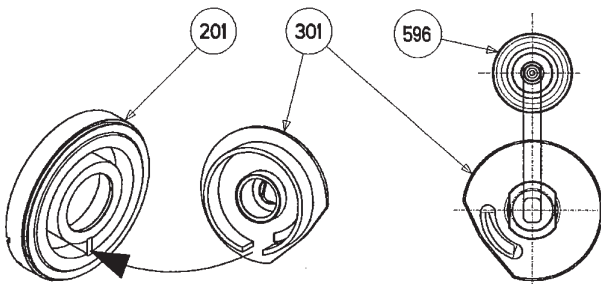

- Give a small push to the piston to centre it and engage it in the cylinder, then push it tight to the end while ensuring the oblong hole of the piston is engaged on the 2 flats of the end of the transmission hub **596**.



- Check the state of the seal **305**, replace it if necessary.

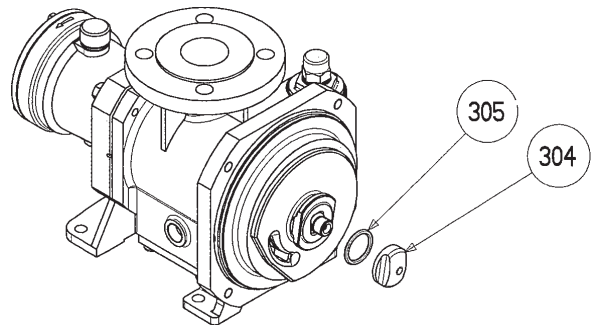

- Place thread locking adhesive (Loctite® 243\* or equivalent) on the thread of the transmission hub **596**.
- Hold the piston **301** with a monkey wrench (opening 50 mm) and screw the nut **304** after first fitting the seal **305**.

**It is important to keep a good grip on the piston, its rotation could lead to deterioration of the bellows. When tightening the nut, comply with the assembly torque of 120 Nm.**

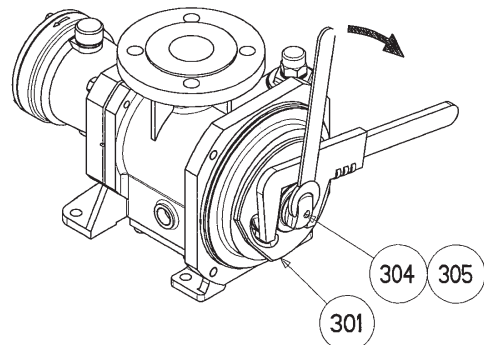

- Check the state of the seal **205**, replace it if necessary.

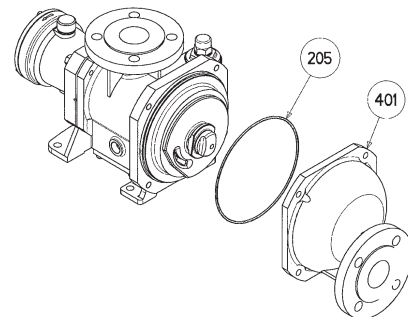

- Re-mount the front cover **401** while positioning the outlet port desired, with its seal **205**.
- Screw the 4 screws **106** (4 x M12 assembly torque 50 Nm).

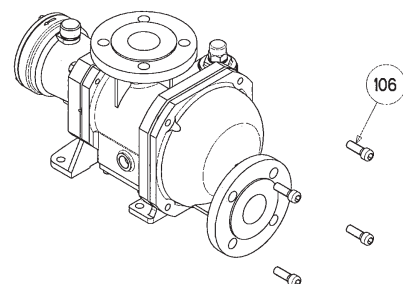

\* Loctite® is a registered trademark.

## 7. PROTECTION OF THE BELLOWS



BE CAREFUL WITH THE WEIGHT OF THE PARTS WHEN THEY ARE BEING REMOVED.

- Dismantle the cylinder/piston couple (see corresponding §).
- Remove the 2 fixing screws from the base frame of the main body **101**.
- On the drive side, remove the 4 screws **111**.

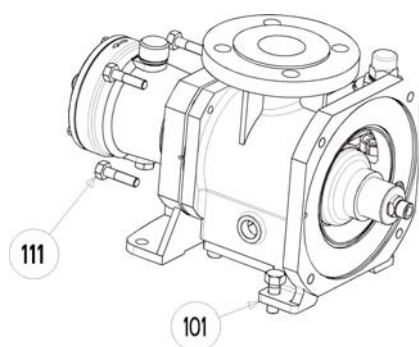

- With the help of a mallet, lightly tap the main body **101** to free it from the transmission **596**.
- Remove the main body **101** while taking care of impact.
- Remove the seal **113** (change it if necessary).
- Inspect the bellows : any impact, scratch or distortion necessitates its replacement.

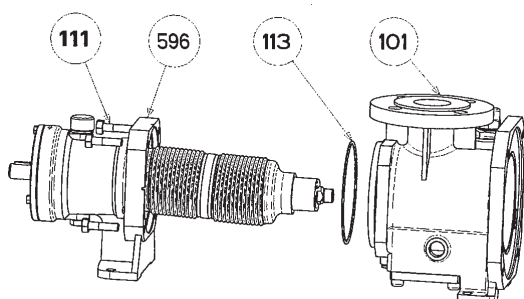

- Assembly is undertaken in the reverse order of dismantling, taking care to correctly position the seal **113** and main body **101**. The screws **111** must be re-mounted with thread locking adhesive (Loctite® 243\* or equivalent) : 4 x M10 : Assembly torque 30 Nm.

Under preventive maintenance (every 225 millions of cycles duty) or in case of damage of the bellows, we suggest transmission exchange program.

In this case : The transmission delivered is equipped with a tubular foam protection. We advise leaving this protection around the bellows until re-mounting of the piston and cylinder.



DO NOT FORGET TO REMOVE THE PROTECTION BEFORE MOUNTING THE CYLINDER.



\* Loctite® is a registered trademark.

## 8. CHANGING THE LIP SEALS

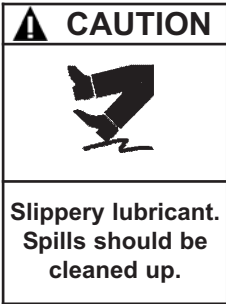

THE PUMP LUBRICANT IS VERY SLIPPERY AND MAY CAUSE SERIOUS INJURY. ANY SPILLS MUST BE CLEANED UP.

- Drain the pump bearing (see corresponding §).
- Unscrew the 3 screws **609**.
- Remove the cover **607** with its lip seals **608** and the seal **602**.

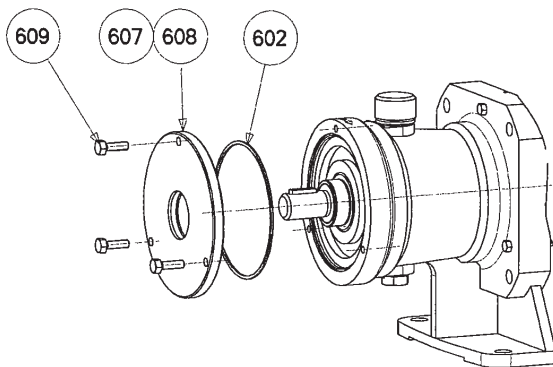

- Extract the 2 lip seals **608**, grease the lips of the seals and grease between the 2 seals **608**.



**FOOD SYNTHETIC GREASE :**  
Compulsory reference because compatible with the standard MOVEX bearing oil.

- Fit, one by one, 2 new seals **608**, on the same side, lip directed towards the interior of the transmission.

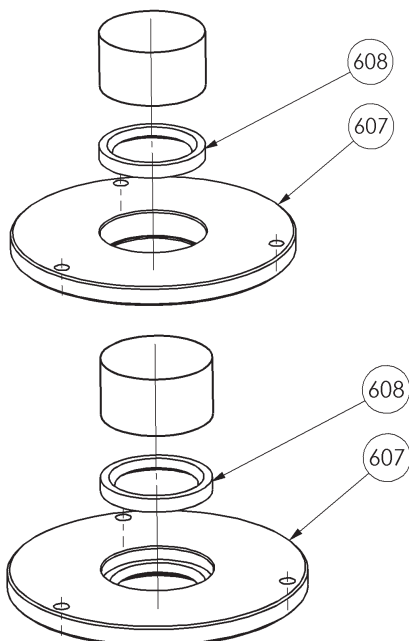

- If the seal face is marked, change the ring **507**. Break the ring with a chisel then fit a new ring after heating it at 95°C (in an oil bath or at HF).
- Re-mount the cover **607** with the 3 screws **609** after placing the seal **602**.
- After replacing the drain bung **773** with its lip seal **774**, fill the bearing with :
  - 0,7 litre of oil (C4 A - C8 A)\*.
  - 2 litres of oil (C4 A HT - C8 A HT)\*.
 See § DRAINING OF BEARING.
- Screw back the breather **715**.

**C4 A - C8 A**

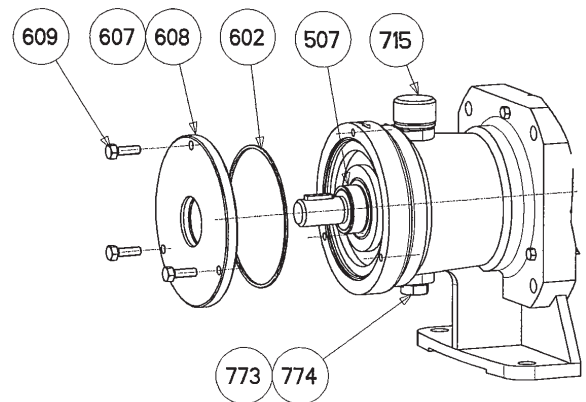

**C4 A HT - C8 A HT**

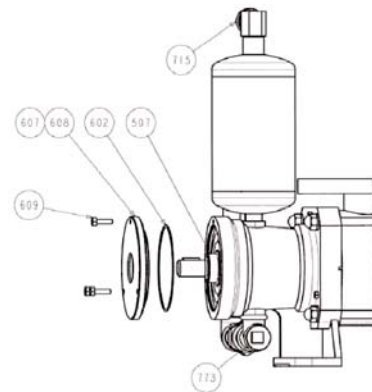

\* Standard oil provided by MOVEX : CS05 Food synthetic oil (Safety data sheet is supplied with the new pump and on inquiry).

\* Other oil provided by customer.

## 9. CHANGING THE ORIENTATION OF THE DISCHARGE PORT



BE CAREFUL WITH THE WEIGHT OF THE PARTS WHEN THEY ARE BEING REMOVED.

- Unscrew the 4 screws **106**.
- Turn the front cover **401** so as to position the outlet port in the desired position.
- Replace the 4 screws **106** (6 x M12 : assembly torque 50 Nm).

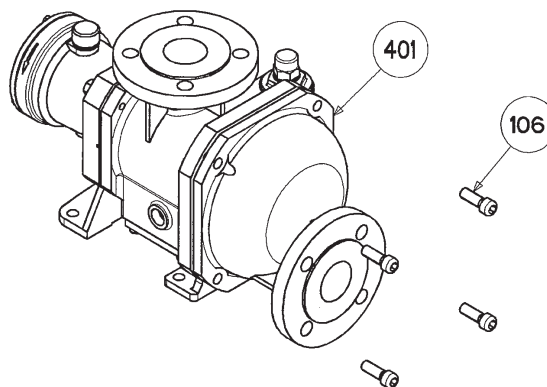

# 10. BYPASS

## 10.1 BYPASS ADJUSTMENT

- Remove the plug **833** as well as the seal **832**.
- Using a flat spanner, turn nut **834** clockwise to obtain a greater pressure (tightening of the spring) or counter-clockwise to obtain a lower pressure (loosening of the spring).
- Refit plug **833** and its seal **832**.

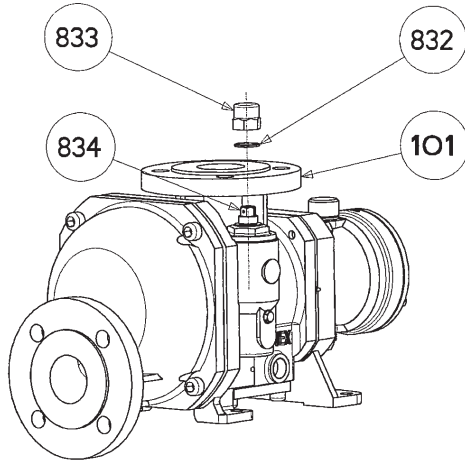

Spring	Adjustement range (bar)	C4	C8
C 2,5	1,5 - 2,5	X	X
C 3,5	2,1 - 3,5	X	X
C 5	3 - 5		X
C 8	3 - 8	X	X

## 10.2 CHANGING THE SPRING



FAILURE TO RELIEVE SYSTEM PRESSURE PRIOR TO PERFORMING PUMP SERVICE OR MAINTENANCE CAN CAUSE PERSONAL INJURY OR PROPERTY DAMAGE.

- Loosen the spring (see § BYPASS ADJUSTMENT).
- Loosen the pressure screw nut **828** of main body **101** taking care to the thrust produced by spring **804** (do not remove any associated parts).
- Remove the spring **804**.
- Replace spring **804** and carry out reassembly in reverse order of disassembly.

## 10.3 REPLACEMENT OF THE SEALS

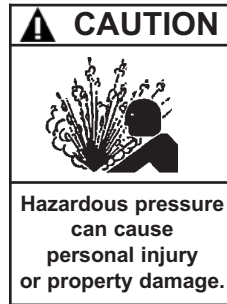

FAILURE TO RELIEVE SYSTEM PRESSURE PRIOR TO PERFORMING PUMP SERVICE OR MAINTENANCE CAN CAUSE PERSONAL INJURY OR PROPERTY DAMAGE.

- Loosen the spring (see § BYPASS ADJUSTMENT).
- Loosen the pressure screw nut **828** of main body **101** taking care to the thrust produced by spring **804**.
- Block the unit comprising the pressure screw nut **828** in a vice.
- Using a pin drift, remove pin **831**.
- Remove the nut **834**.
- Remove the screw **826**, the spring **829**, the seal **837** and the washer **838**.
- Replace seals and reinstall in reverse order of disassembly.

### NOTICE :

When assembling seal **837**, we recommend covering the pin hole on shaft **826** with adhesive tape to avoid damaging the seal.

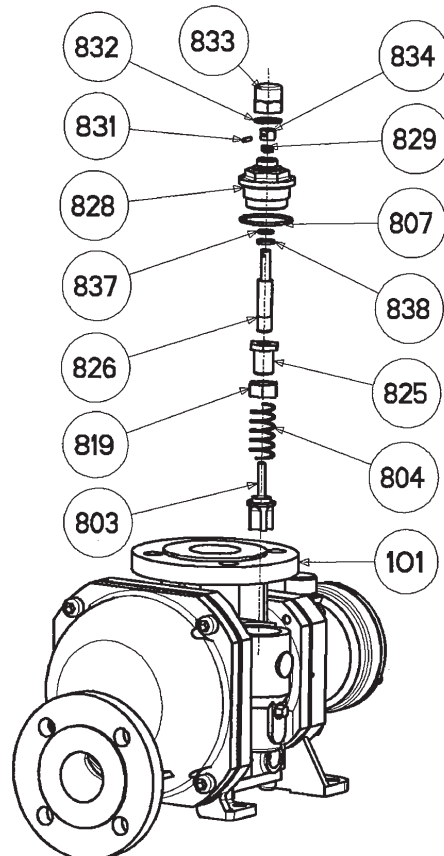

# 11. HEATING JACKET (option)

## 11.1 REPLACEMENT OF THE JACKET SEAL

Before carrying out any work, make sure that no fluid flows in the casing (heating / cooling circuit valve closed) and that the pump is at ambient temperature.

**⚠ WARNING**



Hazardous pressure can cause personal injury or property damage.

DISCONNECTING THE FLUID OR PRESSURE CONTAINMENT COMPONENTS DURING PUMP OPERATION CAN CAUSE SERIOUS PERSONAL INJURY, DEATH OR MAJOR PROPERTY DAMAGE.

- Remove the 4 screws **132** from the main body **101** as well as the main body plate **131** and the seal **130**.
- Reassembly is in reverse order of disassembly.

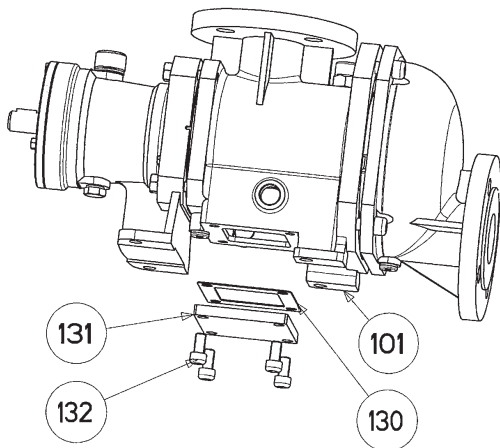

## 11.2 BLEED (included with jacket option)

- A bleed is provided on the main body **101** and the front cover **401** (only in position 2 or 4 for the front cover - see board "Possible positions" § INSTALLATION).
- Using an Allen key, unscrew the screws **122**.
- Check the state of the seal **121**, replace it if necessary.
- Reassembly is in reverse order of disassembly.

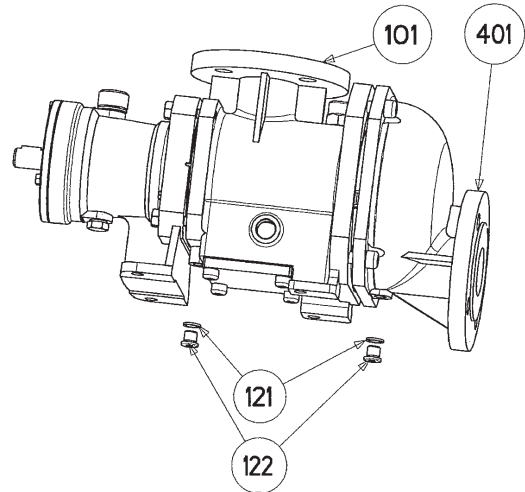

## 12. DRAINING OF BEARING

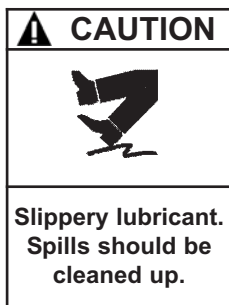

THE PUMP LUBRICANT IS VERY SLIPPERY AND MAY CAUSE SERIOUS INJURY. ANY SPILLS MUST BE CLEANED UP.

- Drain the transmission following the board below :

- **Data with standard MOUVEX oil :**

Temperature of product pumped / heating product	Draining interval (running hours)
150 °C < T ≤ 160 °C	800
135 °C < T ≤ 150 °C	1 500
120 °C < T ≤ 135 °C	3 000
100 °C < T ≤ 120 °C	6 000
80 °C < T ≤ 100 °C	12 000
T ≤ 80 °C	24 000

- **Data with other customer oil :** the drawing interval is defined by the customer (tests results) regarding the oil specifications and the pump conditions.

- Drain the pump by removing the drain bung with its seal **773-774** and the breather **715**.
- Replace the drain bung and its seal.
- Fill the transmission with :
  - 0,7 litre of oil (C4 A - C8 A)\*.
  - 2 litres of oil (C4 A HT - C8 A HT)\*
- Check oil level that the level is between 1 and 5 mm above the schaft.

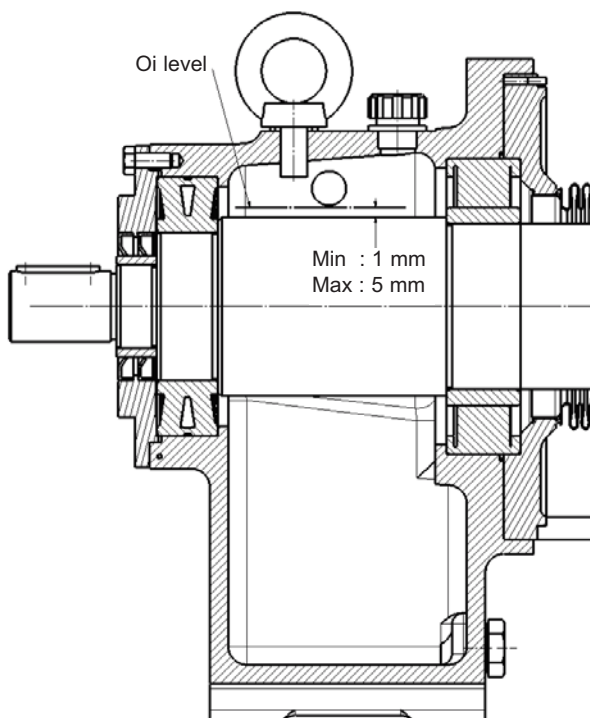

- Screw back the breather **715**.

**C4 A - C8 A**

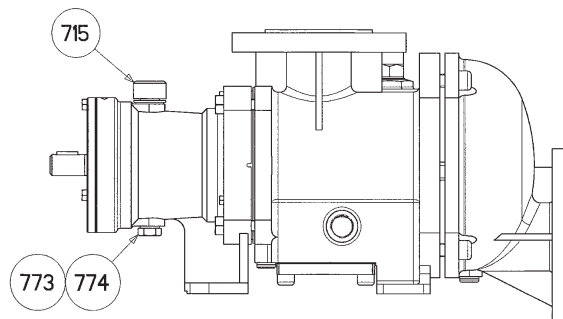

**C4 A HT - C8 A HT**

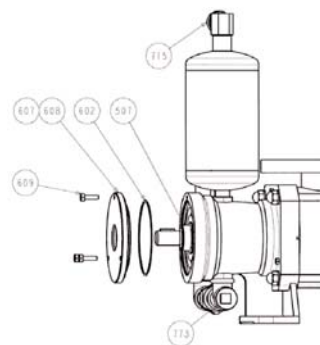

\* Standard oil provided by MOUVEX : CS05 Food synthetic oil (Safety data sheet is supplied with the new pump and on inquiry).

\* Other oil provided by customer.